

Use Case Diagram: Football Stadium

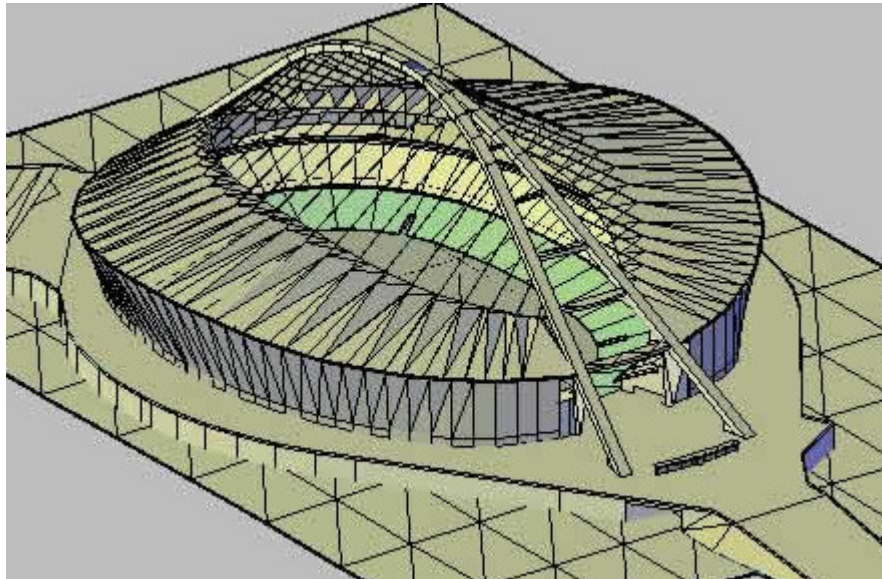

(taken from the Internet, just as example)

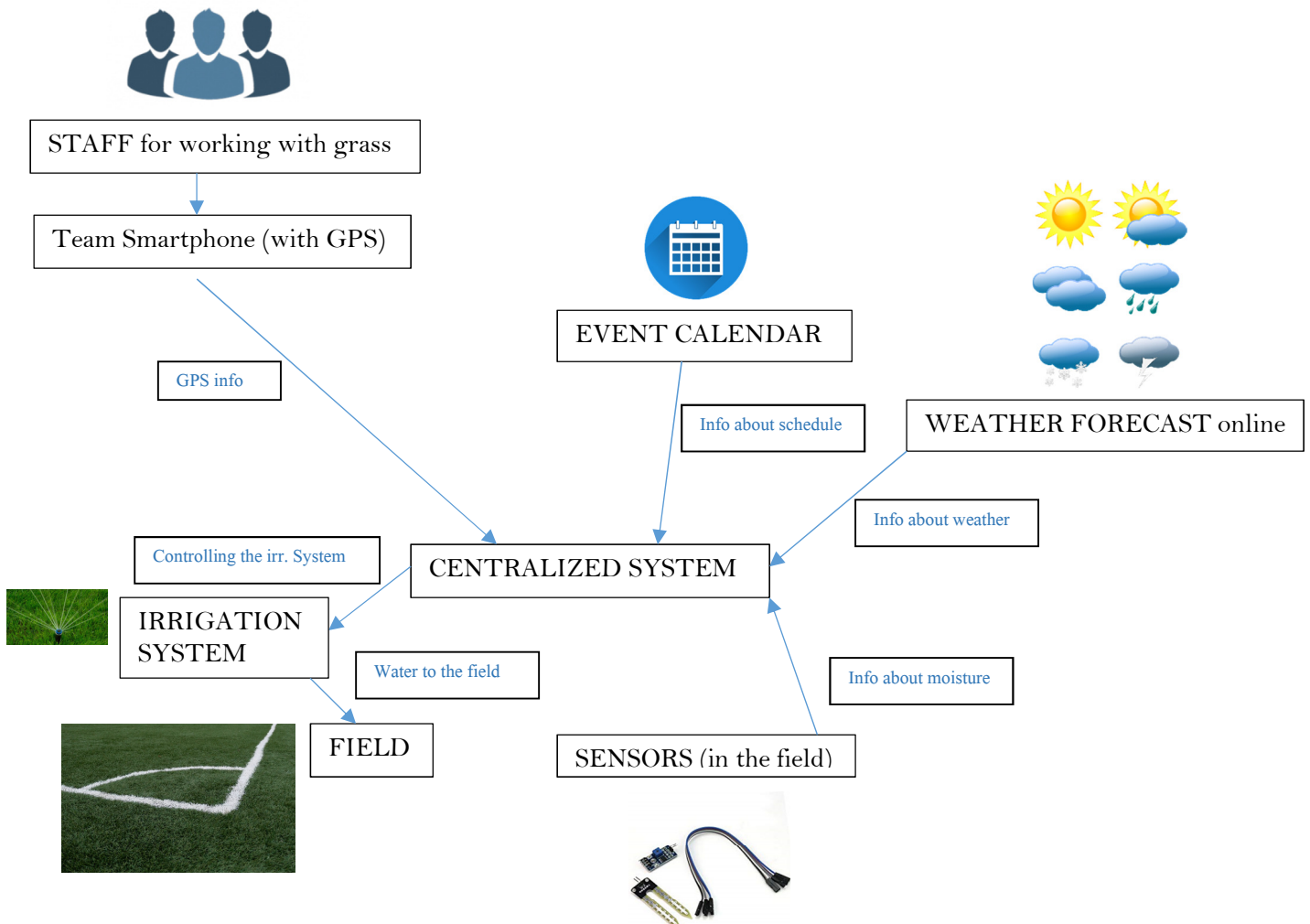

In this example we have a football stadium. The field needs to be taken care by the staff working on the grass, and by being watered regularly. In order to have all managed automatically, the irrigation system is controlled by a centralized system, which receives information about the events schedule, position of the staff responsible of the grass and weather forecast.

The irrigation system will work in accordance with the temperature of the day, the moisture of the ground and the forecast for the next hours (if it is going to rain there is no sense in spending money for water and electricity). Furthermore, the system will not start if someone of the staff is working in that moment on the grass (the position is obtained through the GPS on the smartphones of the staff crew), in order to not make them wet. If one event is scheduled in that day, the system will change his timing accordingly with the start and the end of the game itself.